

PARTS AND HARDWARE LISTING
LISTE DES PIÈCES ET QUINCAILLERIE

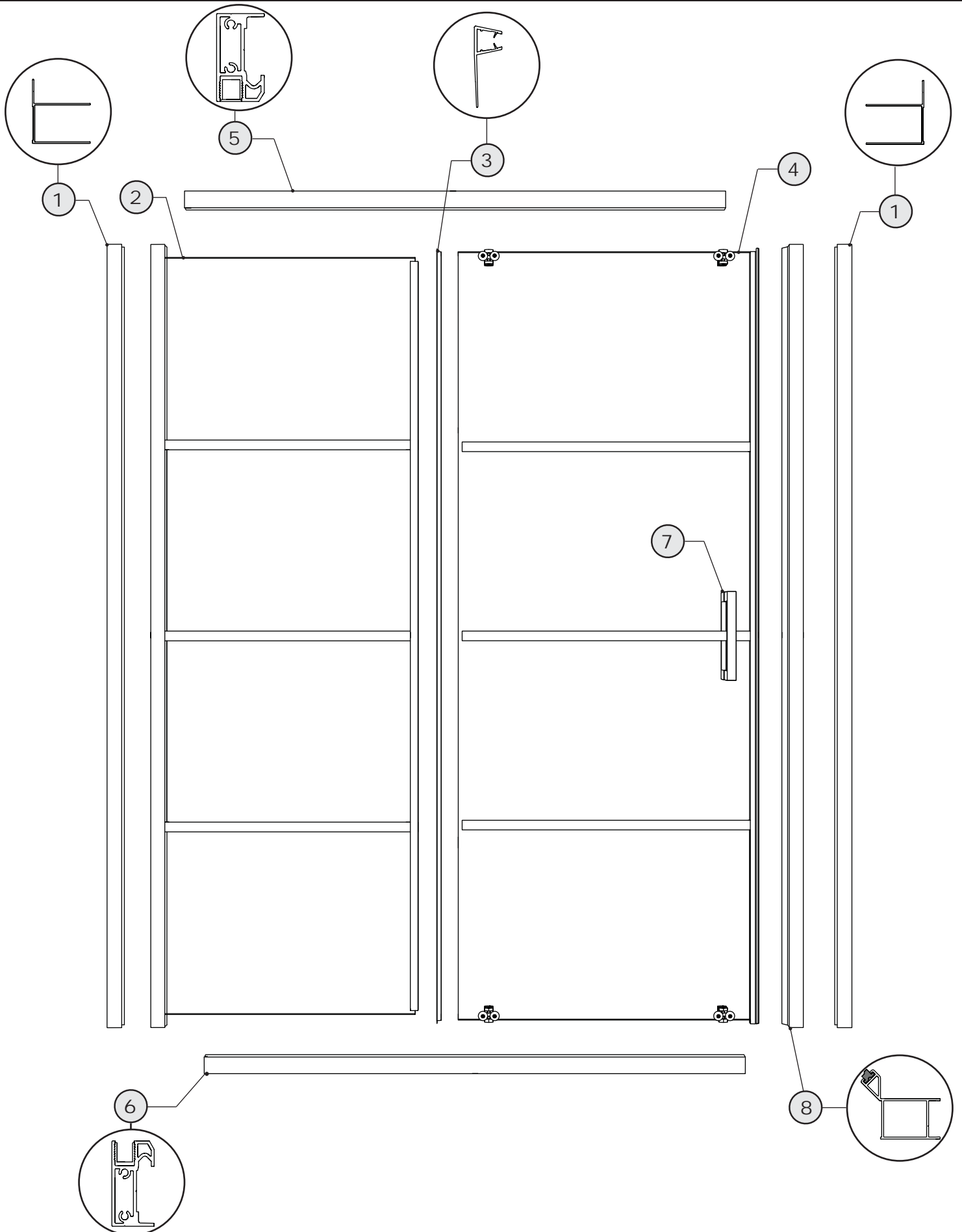

PARTS LISTING / LISTE DES PIÈCES



9

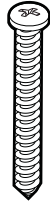

10



11



12



13



14

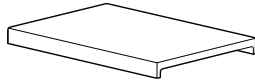

15

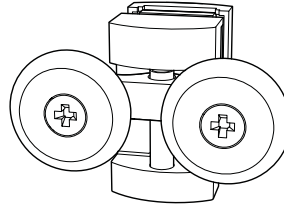

16

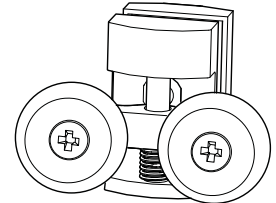

17

ITEM	FLEURCO CODE	PARTS AND HARDWARE / PIÈCES ET QUINCAILLERIE	QTY
1	LA-WJAMB-33-79	WALL JAMB / JAMBAGE	2
2		FIXED PANEL / PANNEAU FIXE	1
3	COEX LA100-79-33	SIDE GASKET / JOINT LATÉRAL DE LA PORTE	1
4		DOOR PANEL / PANNEAU DE PORTE	1
5	LA-RAIL-**-L	TOP TRACK / RAIL DU HAUT	1
6	LA-RAIL-**-R	BOTTOM TRACK / RAIL DU BAS	1
7		HANDLE / POIGNÉE	1
8	LA-MAGEXP-33-79	MAGNETIC EXPANDER / EXTENSEUR MAGNÉTIQUE	1
9		WALL PLUG / CHEVILLE	6
10		PAN HEAD SCREW / VIS À TÊTE CYLINDRIQUE	14
11		PAN SELF-DRILLING SCREW / VIS PAN AUTO-PERÇANTE	6
12		BACK SCREW CAP / CAPUCHON COUVRE-VIS ARRIERE	12
13		SCREW CAP / CAPUCHON COUVRE-VIS	12
14	LA-EXP-CAP-33-79	FRAME CAP / CAPUCHON DU CADRE	2
15	LA-WJCAP-33	WALL JAMB CAP / CAPUCHON DU JAMBAGE	2
16	LA-ROLLER-TOP-33	TOP WHEEL / ROULETTE DU HAUT	2
17	LA-ROLLER-BTM-33	BOTTOM WHEEL / ROULETTE DU BAS	2